

PAN & PARK SLOTTING

120'-0" ROAD FROM LOKANANDWALA CIRCLE TO KRANTINAGAR RIKSHA STAND

DCG NO. AC/15/149/NO.1

① C-45

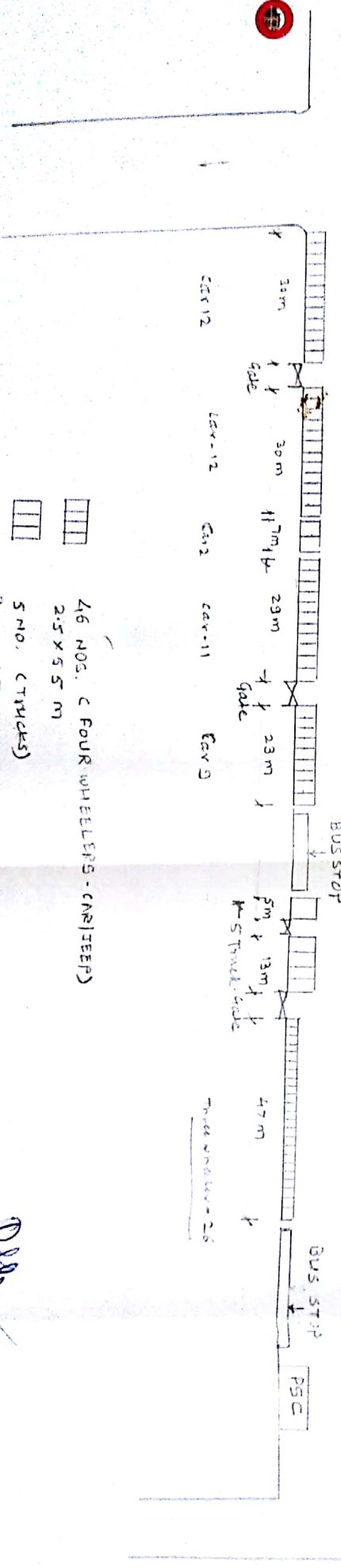
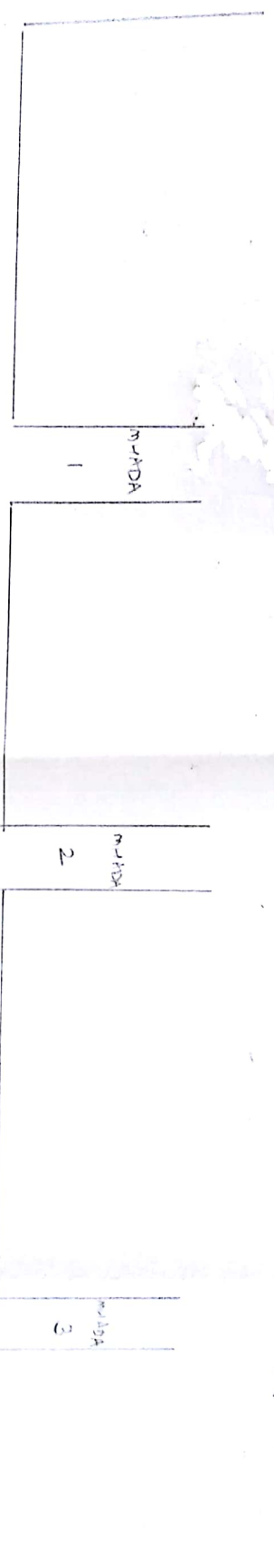

- 46 NOS. C FOUR WHEELERS - (CAR/TEMP)
- 2.5 X 5.5 M
- 5 NO. (TRUCKS)
- 3.05 X 6.50 M
- 26 NO. (THREE WHEELERS)
- 1.80 X 2.40 M

AT (S&C) N (ALCM)

ANUDATTA  
SCHOOL

PART PARK LOT AT 1340M ROAD SAPPHIRE HEIGHT BLD TO ANUDATTA SCHOOL

DRN NO AC/15/P/P/NO.2

2

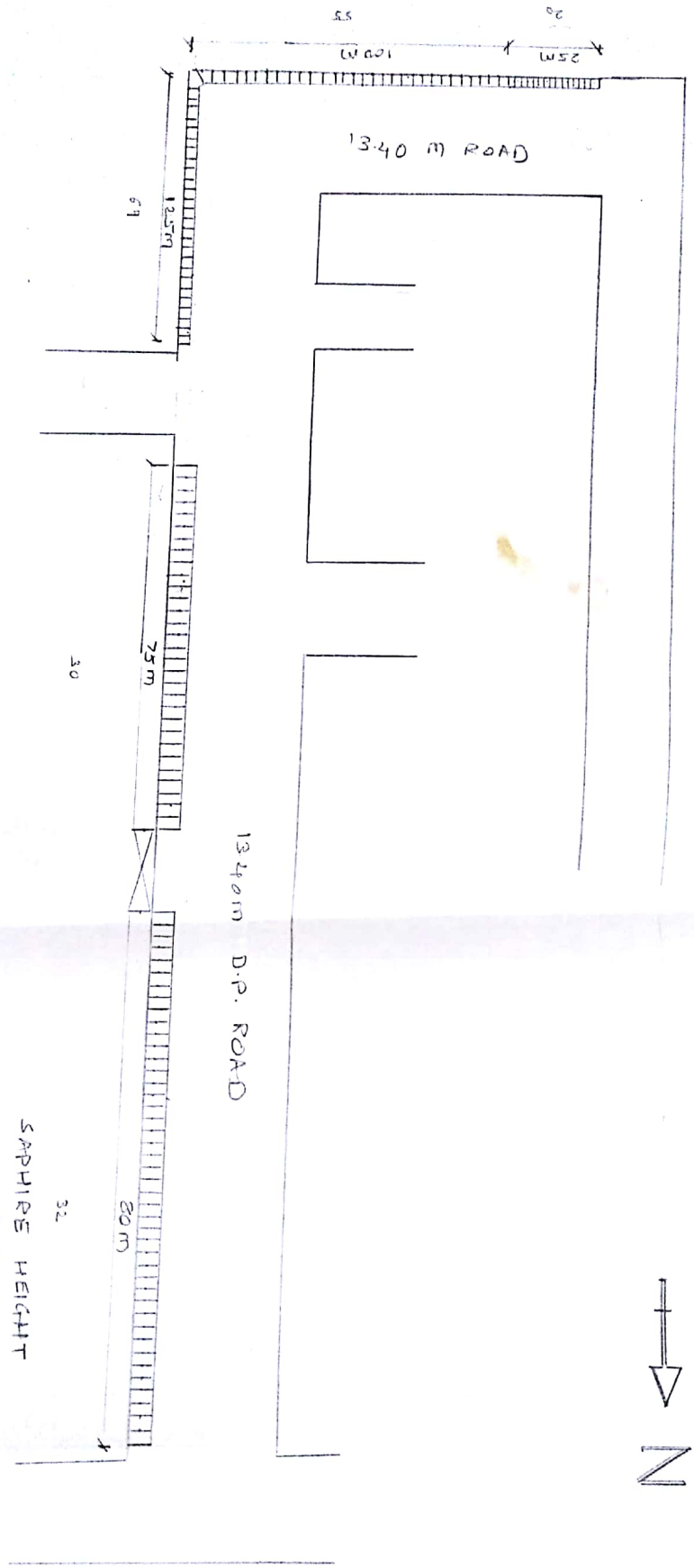

- 20 NOS. (TWO WHEELERS)  
1.20M X 2.40M
- 124 NOS. (THREE WHEELERS)  
1.80M X 2.40M
- 62 NOS. (FOUR WHEELERS)  
2.50M X 5.50M

BL  
56CM

NECM

PAY 4 PARK LOT AT 13.40M ROAD GREEN HILL CHS TO SAPPHIRE HEIGHT BLD. ROAD

DRAWN ACC/PL/PP/NO.3

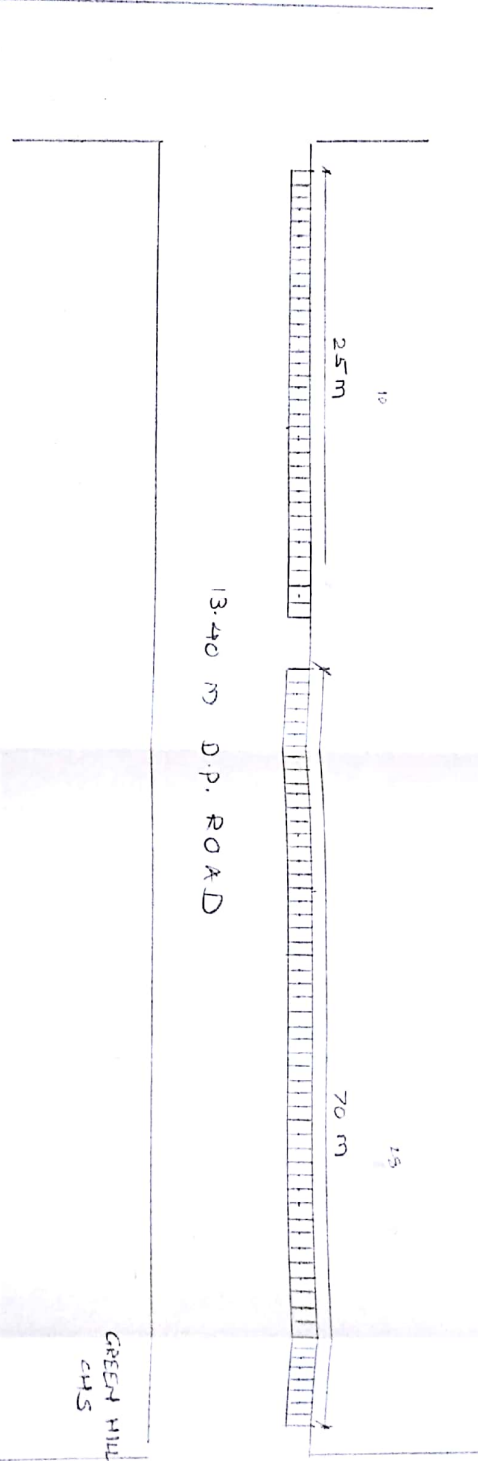

SAPPHIRE HEIGHT BLD.

 38 HDS (FOUR WHEELERS)  
 2.5 X 5.5 M

①X  
5C (M)

4C (M)

PAY & PARK LOT AT 13440 M ROAD, AHITA VIHAR CHS TO AHUDATTA SCHOOL



SP. NO. ACRES/RAH/104

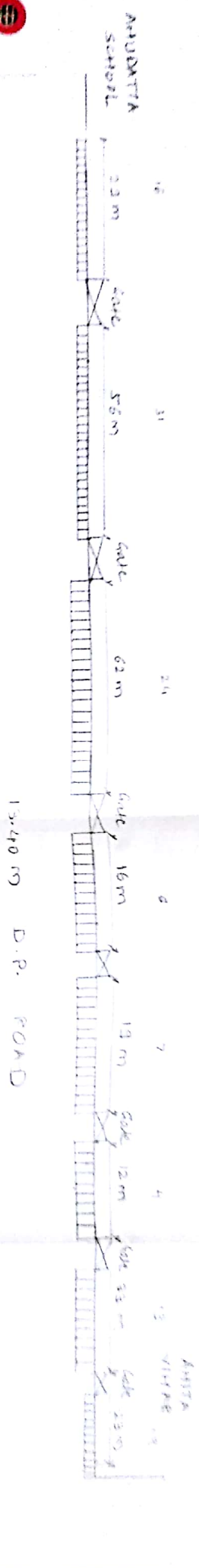

- 19 NOS. (TIPO WHEELER)
- 12 NOS X 2.4M
- 47 NOS (THREE WHEELERS)
- 120M X 2.4M
- 54 NOS (FOUR WHEELERS)
- 2.5M X 5.5M

50m

180m

PART OF PARK LOT AT 13400N ROAD, ESBEL CHS TO SAPPHIRE HEIGHT BLD. ROAD

DRG. NO. AC/PS/PAP/NO. 5



13400N D.P. ROAD

SAPPHIRE HEIGHT BLD. ROAD

ESBEL CHS

40 NOS (FOUR WHEELERS)  
2.50M X 5.50M

① (56M)

② (15CM)

⑤ (1.53)



PAY & PARK SLOT AT 13.40M ROAD NEIGHBOURHOOD CHS TO SAPPHIRE HEIGHT BID ROAD

BRG No Acpl5/P4P/NO.6

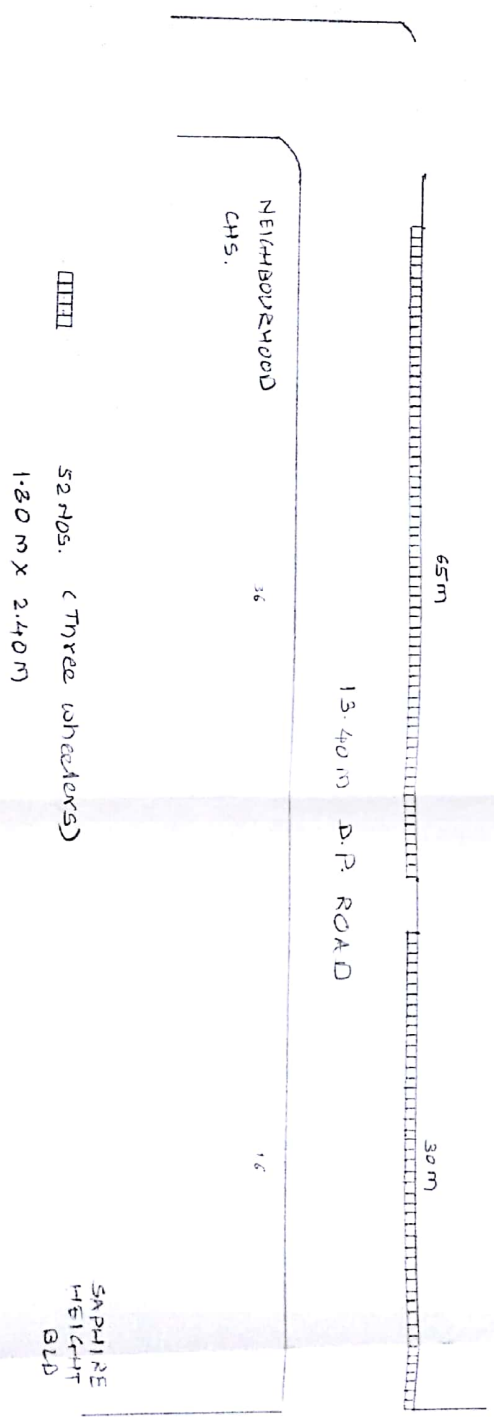

AT  
55 (m)

AB (m)

52 nos. (T)ree wheelers  
1.80m x 2.40m

PART PARK SLOT AT 18.30M ROAD HIGHLAND CHS TO NEIGHBOURHOOD CHS

DRG No AC/21/PAP/1407

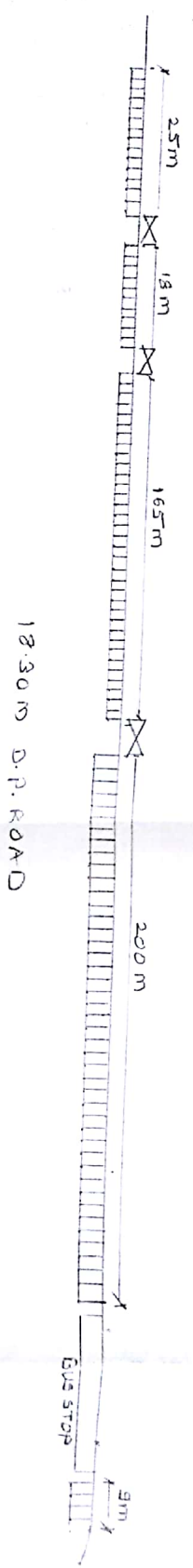

Highland  
CHS.

13 10 91 80

Neighbourhood  
CHS.



114 nos. (Three wheelers)



83 nos. (Four wheelers)

2.50m x 5.37m

56 (sq)

Accm)

7/57

PAY PARK SLOT AT 13.40M ROAD GREEN MEDOS CHS TO NEAR ABDUL HAMEED GARDEN ROAD.

DR. AS ACP/14/14/10.8

(3)

L-19



Lehanda  
Gard

18.30M D.P. ROAD

Green Medos  
CHS. CH

13.40M D.P. ROAD

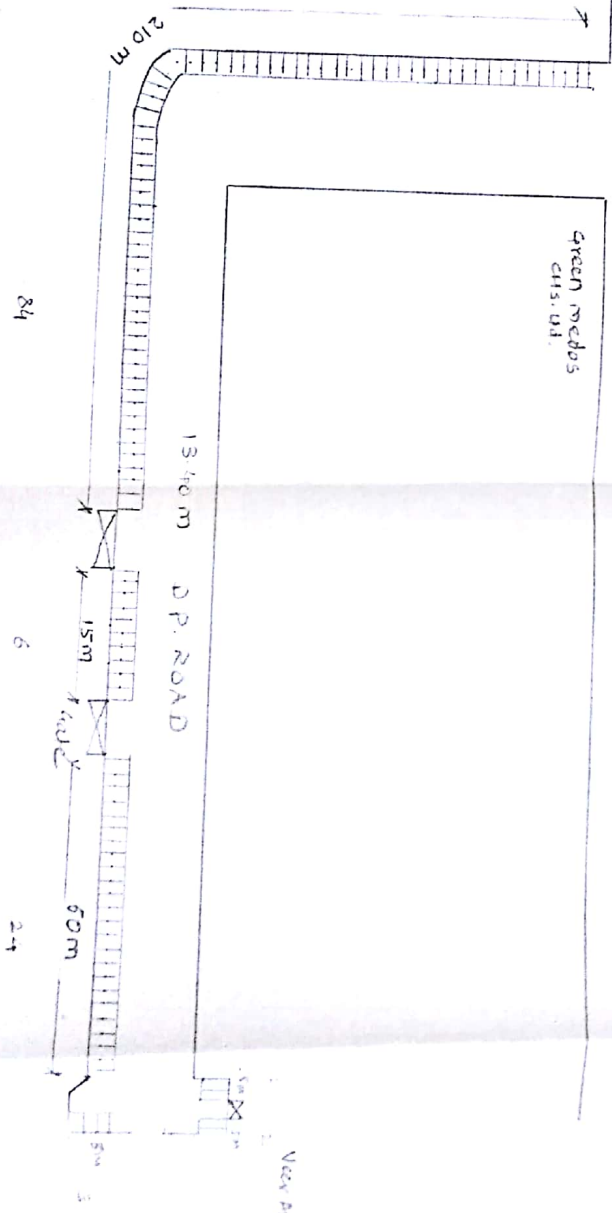

121 NOS. (Four wheepers)  
2.50M X 5.50M



AT  
56cm

ABcm



PART PARK SLOT AT 60'-0" ROAD MANKAMESHWAR PSC TO P/N BOUNDRY ROAD

DR-10 APPL/P/110-3

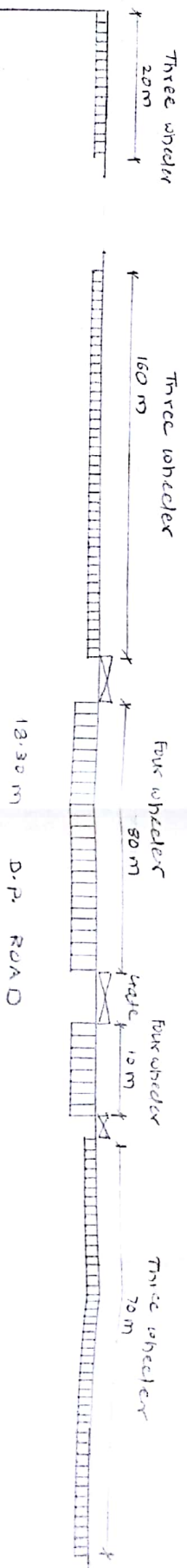

- 11 28
- 137 NOS. (Three wheelers)  
1.80m x 2.40m
- 36 NOS. (Four wheelers)  
2.50 m x 5.50m

AT 58 (4)

ACCM

P/N

(9) 26/11

PAY & PARK SLOT AT 44'-0" ROAD, KRANTINAGAR PIRSHA STAND TO MANKAMESHWAR ROAD

DRUG ACQUISITION



10  
2-103

MHADA ROAD  
No. 3

KRANTINAGAR

13.40 m D.P. ROAD

26m

Three wheeler

5m

Two wheeler

10m

Three wheeler

36.60m

D.P.

ROAD

41 NO. (TWO WHEELER)

1.2 x 2.4 m

199 NO. (THREE WHEELER)

1.8 x 2.4 m

AT  
58m

ACLM

MANKAMESHWAR  
ROAD



